

# WALK WAY WITH CLASSIC 6003

## Contents of Accessory box

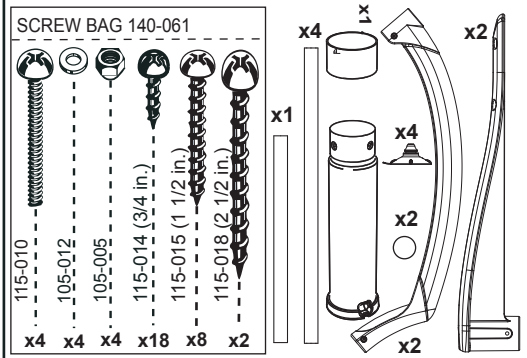

## Contents of ladder box SKU # 6003

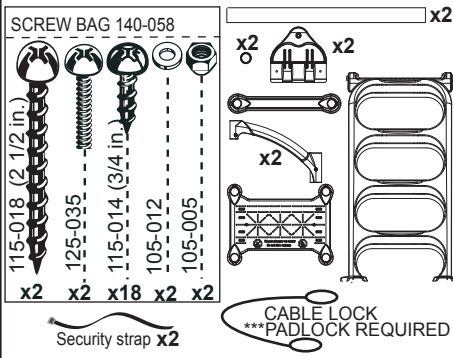

## Walk Way Step

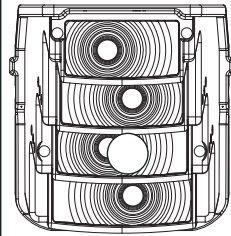

## Sand (Not included)



## ⚠ WARNING

- ◆ Do not dive or jump from the step or ladder.
- ◆ Use BATTERY operated tools to avoid electric shocks.
- ◆ Install step on flat surface, following the manufacturers' instructions .
- ◆ Remove step from pool during freezing climate season.
- ◆ Manufacturer cannot be held responsible for injuries caused by abusive use of product.
- ◆ Ask your city about specific regulations that apply to your above-ground pool and ladder.

## Required tools

(not included)

A weather resistant padlock is recommended.

Maximum functional width is 1/4 inch.

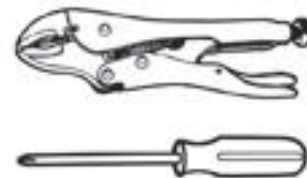
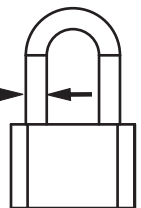

# A

- 1) Flip the Walk Way so that the steps are directly facing the ground.
- 2) Place the support tube, one side at a time, in the pockets located in the bottom lip.
- 3) Flip the step back to its original usage position.
- 4) Secure the support tube to the step with the screws provided.

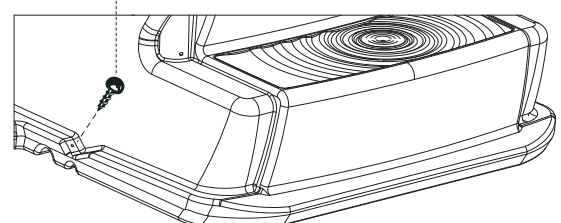
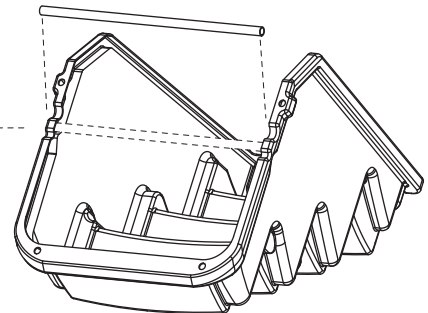

# B

1) Insert the four posts into the step. Secure the posts in place with the bolts, washers and nuts provided.

2) Insert the platform, 2 small handrails, and 2 large handrails over the 2 rear posts. Do not secure.

3) Insert the 4 post covers and secure the large handrails to the posts with the screws provided. Do not secure platform.

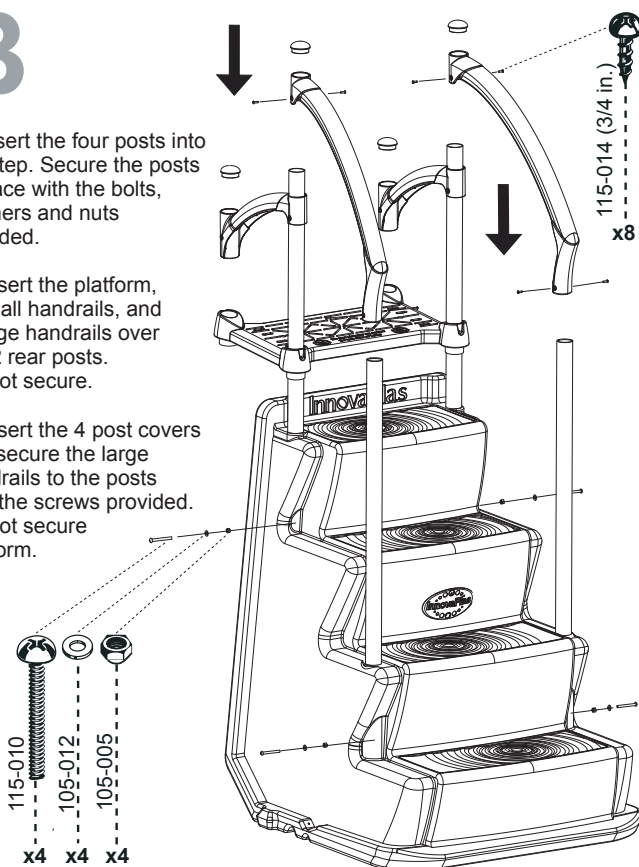

# C

1) Fill the ballast with sand till you reach the top brim.

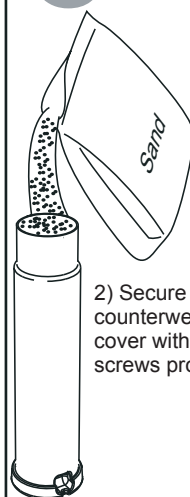

2) Secure the counterweight cover with the screws provided.

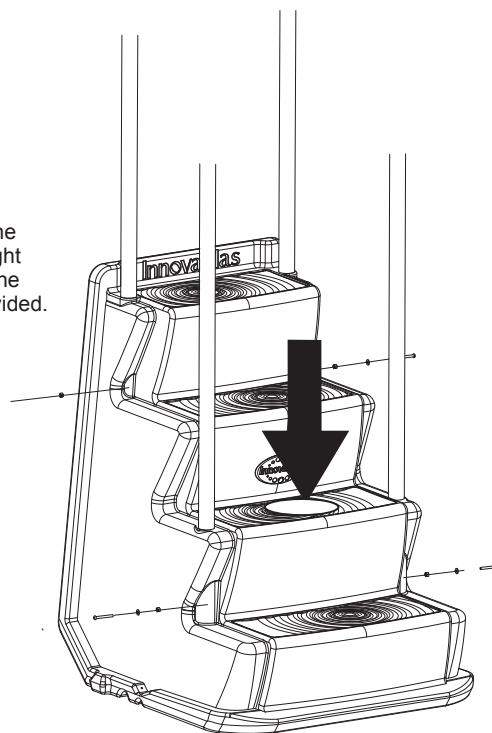

# D

1) Snap the suction cups into the 4 holes under the step. Push while twisting, till the upper cup mushroom has cleared the wall thickness of the step.

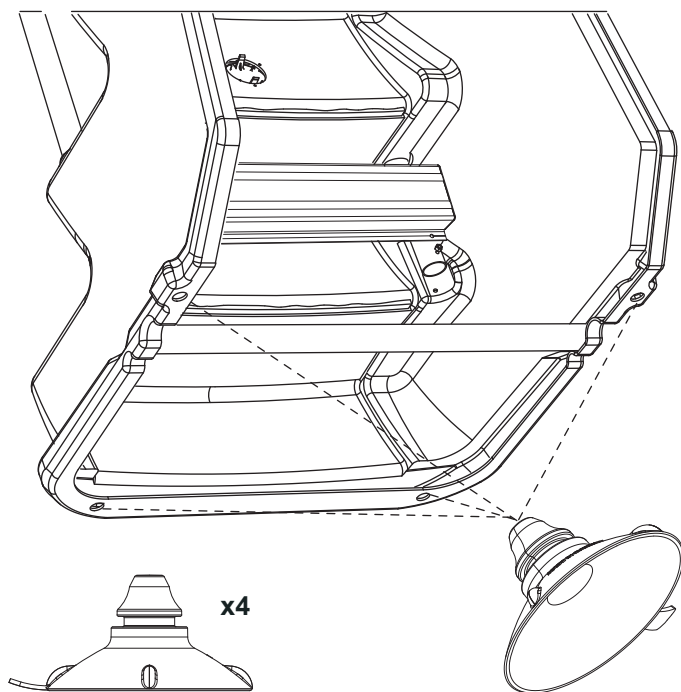

# E

1) Insert the entire step into the pool. Be careful not to damage the pool liner.

2) Slide the platform to the height of the top seat.

**! WARNING**  
MINIMUM OF 1"

To prevent a pool liner puncture, keep a minimum of 1" inch gap between the pool liner and the rear underside of the step.

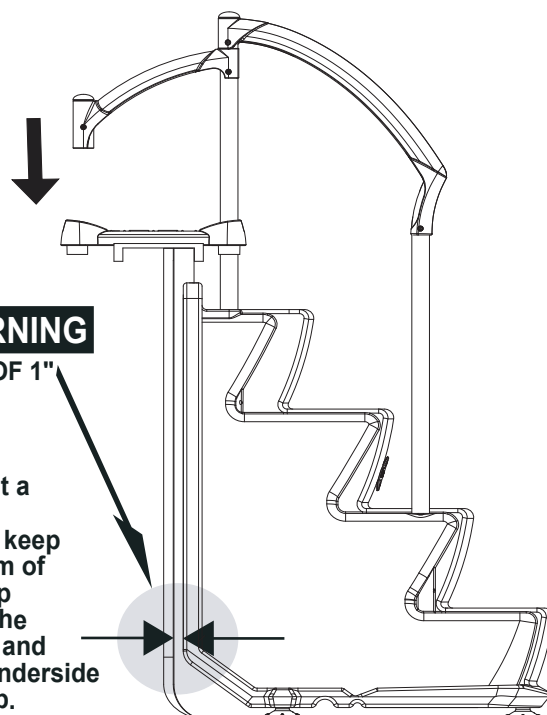

# F

- 1) Once the step is in the pool, secure the platform to the top seat (see illustration) using the two straps provided.

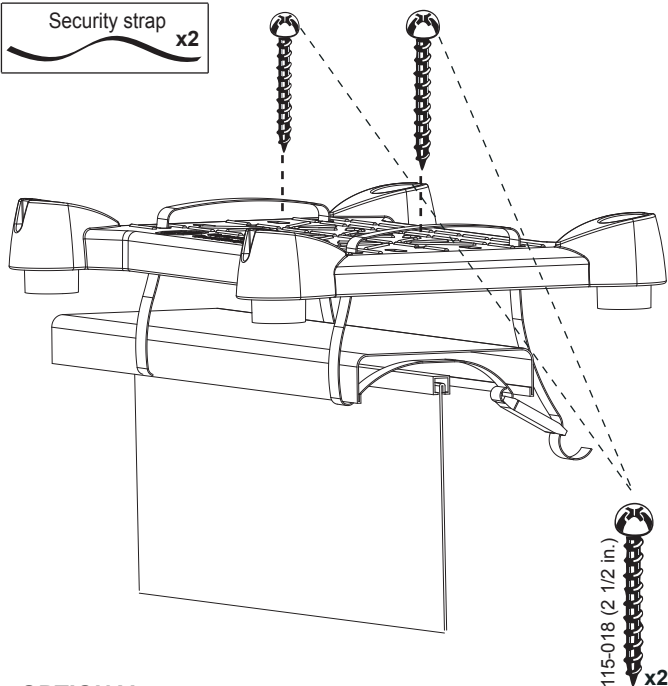

## OPTIONAL:

Once the pool step has been completely assembled and secured to the pool, attach the 2 screws supplied through the platform to the top seat of your pool to provide a more rigid assembly.

# G

- 1) Trace a line on each post at 39 inches from the ground for 48" & 52" Pools. If you have a 54" pool trace a line at 40.5" from the ground.
- 2) Slide the pivot blocks onto the posts and line up with the traced marks. Do NOT Secure yet.
- 3) Slide the 2 posts through the platform and handrails.
- 4) Secure the ladder base to the posts with the screws provided.

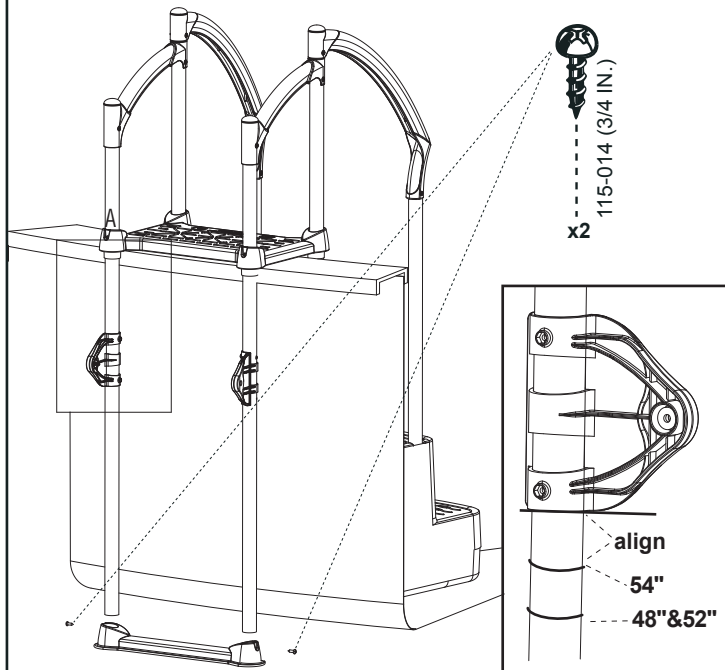

# H

- 1) Secure the small handrails and platform to the posts with the screws provided.
- 2) Secure the ladder to the pivot blocks using the bolts, washers and nuts provided.
- 3) Secure the pivot blocks (FIRST ASSEMBLED TO THE LADDER), to the posts with the screws provided. Make sure the pivot blocks are lined up with the marks traced earlier.

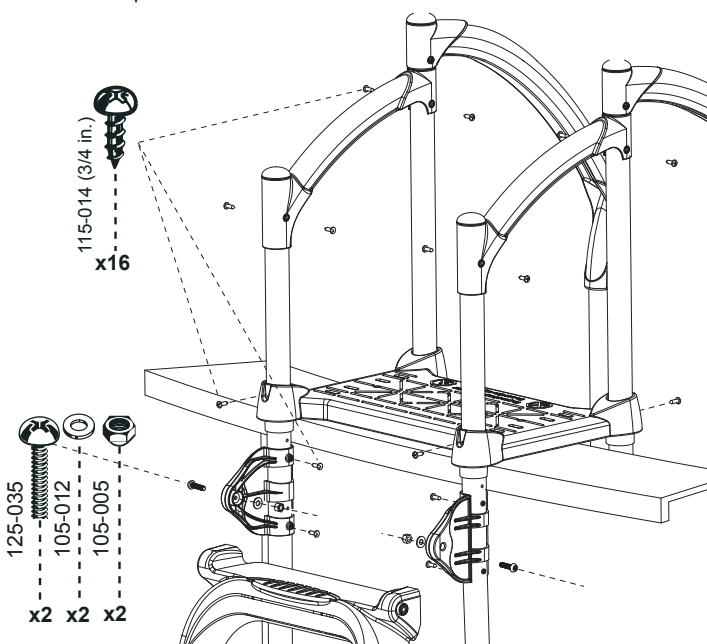

# I

## ⚠ WARNING

**SWING THE LADDER UP AND LOCK IN PLACE WHEN THE POOL IS NOT IN USE TO PREVENT DROWNING AND UNAUTHORIZED ENTRY.**

